

INDEX MAP
SCALE 1"=300'
1" = 300'
150 0 300

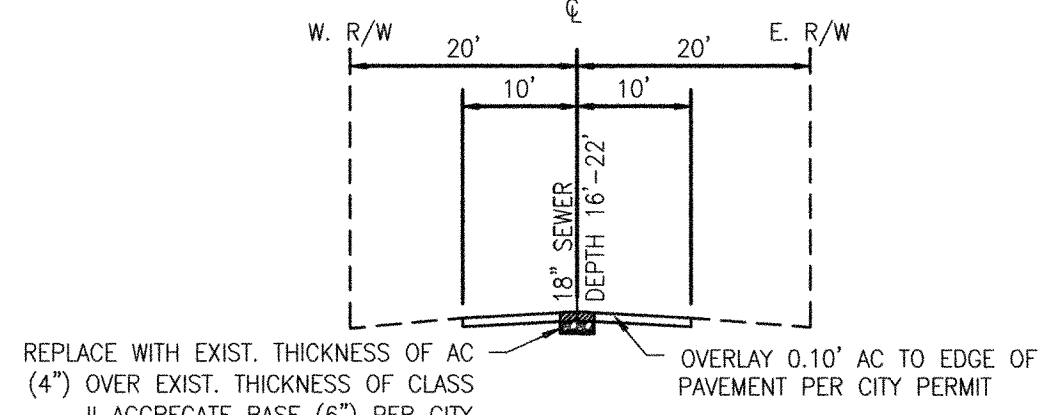

SECTION D-D: SMITH AVENUE
STA. 19+24 TO STA. 28+52
N.T.S.

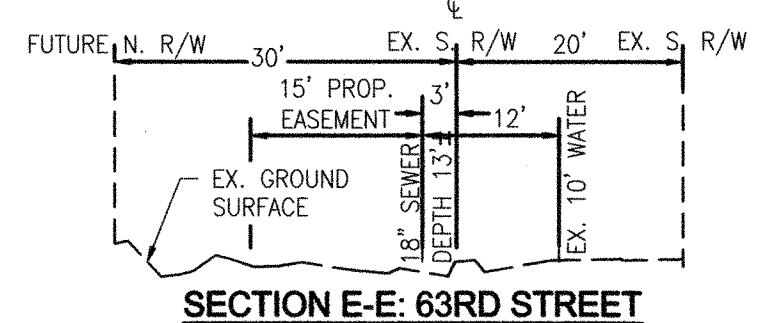

SECTION E-E: 63RD STREET
STA. 10+00 TO STA. 16+69
N.T.S.

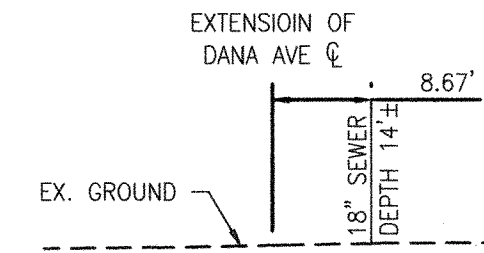

SECTION F-F: EASEMENT
STA. 10+04 TO STA. 13+90
N.T.S.

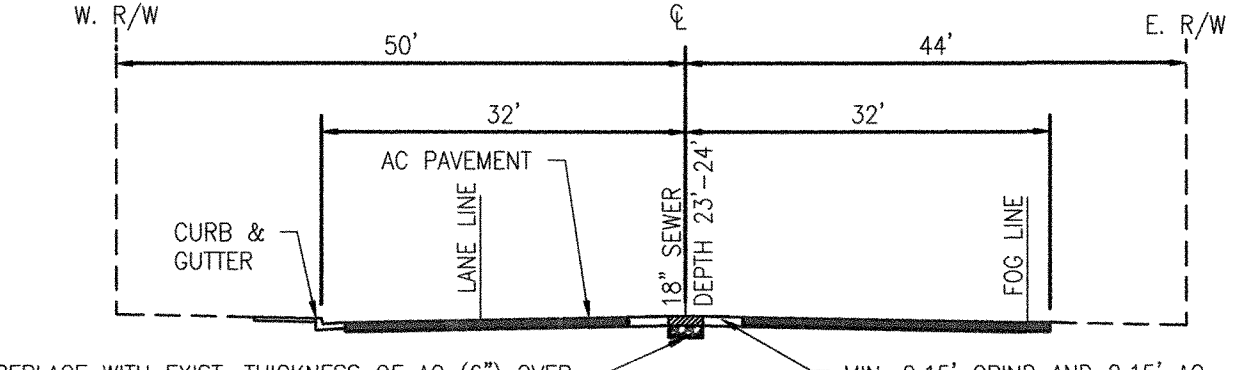

SECTION A-A: WINEVILLE AVENUE
STA. 12+30 TO STA. 21+18, STA. 28+60 TO STA. 35+50
N.T.S.

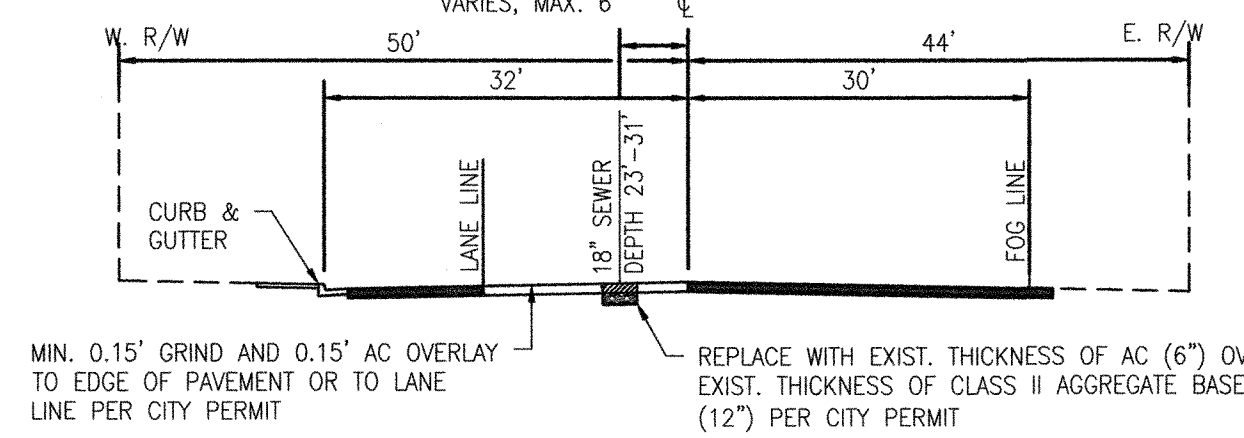

SECTION B-B: WINEVILLE AVENUE
STA. 21+18 TO STA. 26+25
N.T.S.

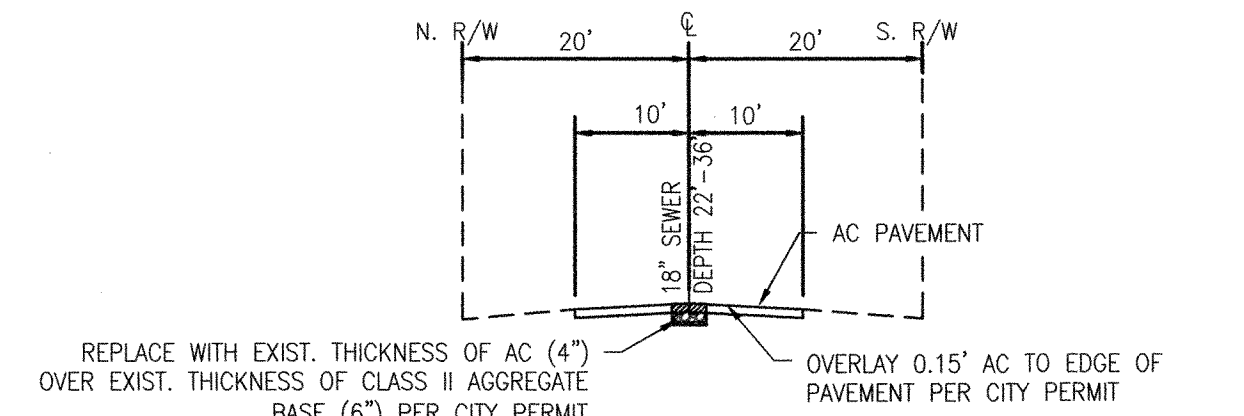

SECTION C-C: 64TH STREET
STA. 21+00 TO STA. 23+50
N.T.S.

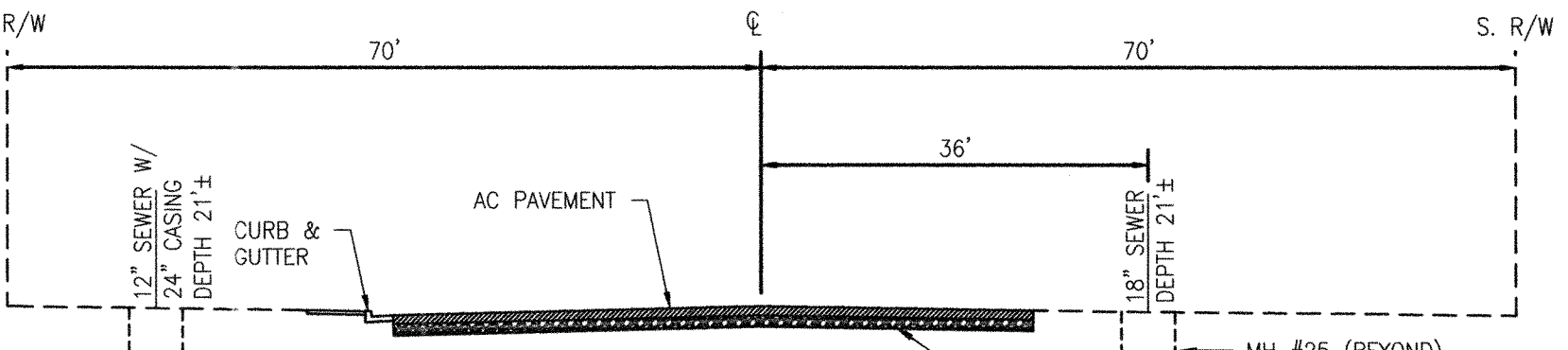

SECTION G-G: LIMONITE AVENUE
STA. 10+10 TO STA. 10+70 SKY 3
N.T.S.

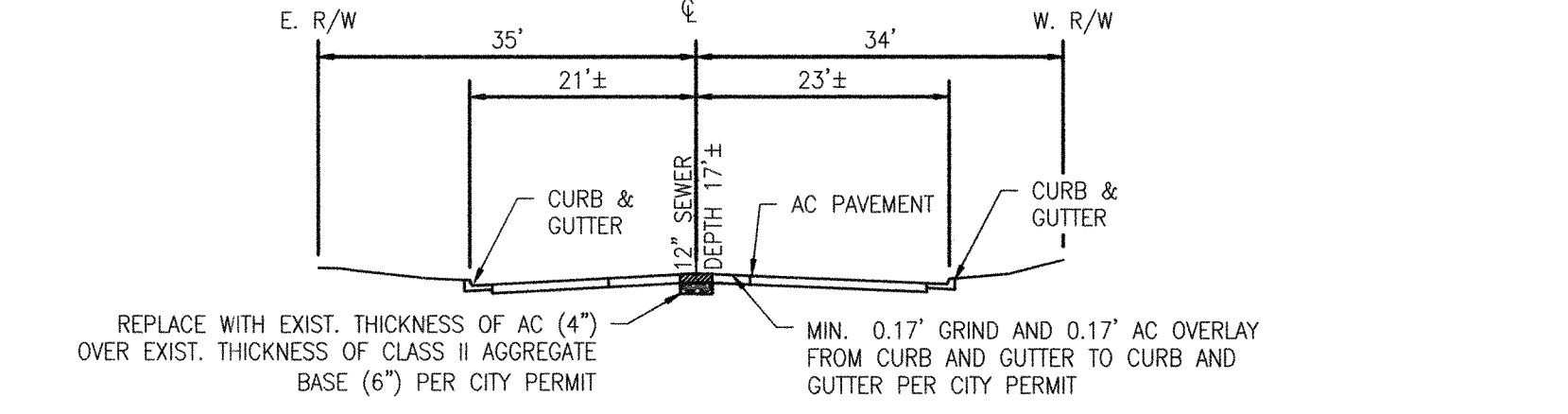

SECTION H-H: LUCRETIA AVENUE
STA. 10+93 TO STA. 13+00
N.T.S.

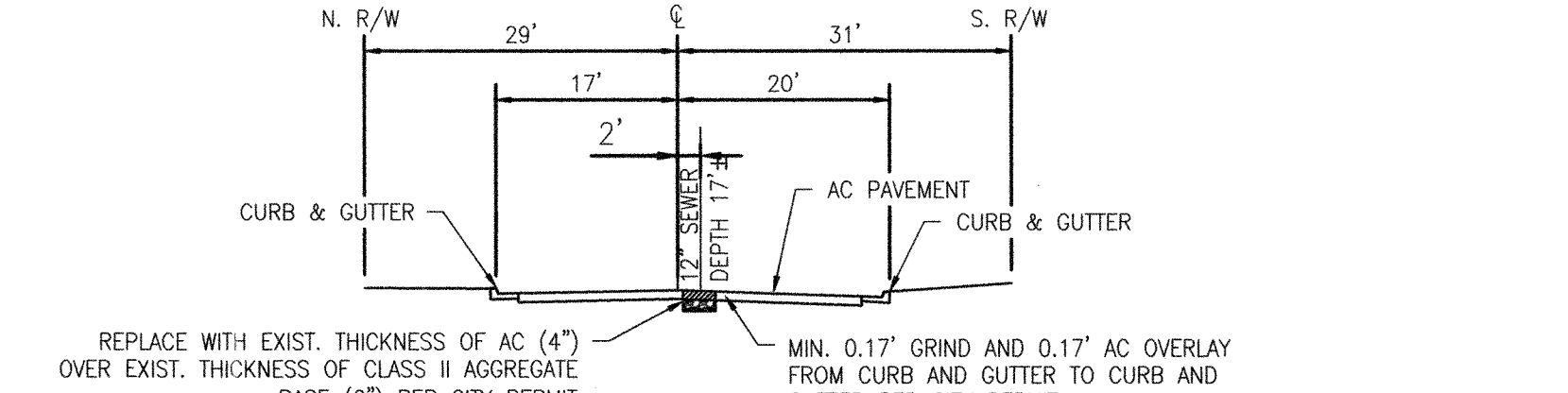

SECTION I-I: SKY COUNTRY AVENUE
STA. 10+02 TO STA. 24+24
N.T.S.

GENERAL SURFACE REPAIR NOTES

- ALL WORK IS TO BE ACCOMPLISHED WITHIN CITY OF JURUPA VALLEY ROAD RIGHT OF WAY ONLY. WHENEVER CONSTRUCTION EXTENDS WITHIN PRIVATE PROPERTY, IT SHALL BE THE RESPONSIBILITY OF THE CONTRACTOR TO SECURE PERMISSION FROM ABUTTING PROPERTY OWNERS PRIOR TO STARTING WORK ON PRIVATE PROPERTY. WRITTEN NOTICE OF APPROVAL IS REQUIRED.
- CLEARED TRACK LAYING CONSTRUCTION EQUIPMENT & MECHANICAL OUTRIGGERS SHALL NOT BE PERMITTED TO OPERATE ON ANY PAVED SURFACE UNLESS FITTED WITH SMOOTH-FACED STREET PADS/RUBBER STREET SHOES. ONLY RUBBER TIERED EQUIPMENT SHALL BE USED IN BACKFILL OPERATIONS IN PAVED AREAS.
- ALL STREET CROSSINGS SHALL BE CUT IN HALF-STREET SECTIONS TO FACILITATE THE FLOW OF TRAFFIC. UNDER NO CIRCUMSTANCES SHALL WORK BE PERFORMED ON THESE CROSSINGS ON WEEKENDS OR HOLIDAYS, UNLESS OTHERWISE SPECIFIED. ALL TRAFFIC PLATES LEFT MUST BE NON-SLIP RATED PLATES AND RECESSED.
- OPEN TRENCHES SHALL BE ATTENDED BY CONTRACTOR'S PERSONNEL AT ALL TIMES. AT THE CLOSE OF EACH WORK DAY, ALL EXCAVATIONS WITHIN THE PAVED AREAS SHALL BE BACKFILLED, COMPACTED, & SURFACED PAVED WITH TWO INCHES OF SC800 TEMPORARY ASPHALT, UNLESS OTHERWISE APPROVED BY THE CITY. THE CITY MAY ALSO APPROVE PROTECTION OF APPROPRIATE AREAS OF TRENCH BY PLATE BRIDGING AND/OR PROTECTIVE FENCING.
- THE CONTRACTOR SHALL REMOVE ANY SURPLUS MATERIAL RESULTING FROM BACKFILL/EXCAVATION OPERATIONS FROM THE RIGHT OF WAY AND BROOM CLEAN ALL PAVED SURFACES OF EARTH & OTHER OBJECTIONABLE MATERIALS IMMEDIATELY AFTER BACKFILL & COMPACTION. THE CONTRACTOR SHALL ACCEPT FULL RESPONSIBILITY FOR COMPLYING WITH ALL NPDES LAWS, REGULATIONS, AND REQUIREMENTS.
- AC CAPS SHALL BE 0.15-FOOT MINIMUM THICKNESS AND SHALL BE PERFORMANCE GRADE (PG) ASPHALT PER RIVERSIDE COUNTY ORDINANCE 461, SECTION 11. ASPHALT DIKES SHALL BE PG 70-10 PAVING ASPHALT, 3/8-INCH MAXIMUM, MEDIUM GRADING.
- THE CONTRACTOR SHALL INSTALL A SEAL ARMOR COAT CONSISTING OF APPLICATION BINDER & SCREENING FOR ALL PATCH AREAS WITH EXISTING SEAL COAT, APPLIED AS SPECIFIED IN RIVERSIDE COUNTY ORDINANCE 461, SECTION 13. A CHIP SEAL ARMOR COAT CONSISTING OF APPLICATION BINDER AND SCREENING SHALL BE APPLIED FOR ALL PATCH AREAS WITH EXISTING CHIP SEAL COAT, APPLIED AS SPECIFIED IN SECTION 37, CALIFORNIA STANDARD SPECIFICATIONS, LATEST ED.
- FOG SEAL SHALL BE APPLIED PER RIVERSIDE COUNTY ORDINANCE 461, SECTION 11.1 OVER ALL PATCHED AREAS AS DETERMINED BY THE CITY, GENERALLY FROM CENTERLINE TO LIP OF GUTTER.
- IF THE EXISTING PAVEMENT ADJACENT TO THE TRENCH IS SCARRED, SPALLED, BROKEN, OR REMOVED DURING CONSTRUCTION, THE CONTRACTOR IS REQUIRED TO REMOVE AND REPLACE THE PAVEMENT IN ACCORDANCE WITH THE PAVEMENT SPECIFICATIONS OF THE PERMIT, AND PLACE A 0.1-FOOT OVERLAY (& SEAL COAT) THE ENTIRE WIDTH OF ONE TRAFFIC LANE. IF THE WORK ENDOUCHES OVER MORE THAN ONE LANE, THE ENTIRE WIDTH OF EACH LANE SHALL RECEIVE THE PAVING CAP; ALL AT NO ADDITIONAL COST TO OWNER.
- SHOULD EXISTING ROLLED BERM OR AC DIKE BE DISTURBED, THE CONTRACTOR SHALL REPLACE AS DIRECTED BY CITY INSPECTOR, IN ACCORDANCE WITH ORDINANCE 461.
- IT IS THE RESPONSIBILITY OF THE CONTRACTOR TO RESTORE ALL TRAFFIC SIGNING AND STRIPING/PAVEMENT MARKINGS DISTURBED AS A RESULT OF CONSTRUCTION. TRAFFIC SIGNING & STRIPING SHALL BE COMPLETED BY THE CONTRACTOR, UNLESS OTHERWISE APPROVED BY THE CITY, WITH ALL INCURRED COSTS BORNE BY THE CONTRACTOR.
- CONTRACTOR SHALL ADHERE TO ALL ADDITIONAL REQUIREMENTS GIVEN IN APPLICABLE CITY OF JURUPA VALLEY PERMITS.

LIFT STATION DEMOLITION SITE NOTES

- PRIOR TO START OF DEMOLITION PHASE, CONTRACTOR SHALL COMPLETE THE CONSTRUCTION AND INSTALLATION, TESTING, START UP AND ACCEPTANCE OF THE SKY COUNTRY TRUNK SEWER LINE DOWNSTREAM OF THE CONNECTION POINT.
- PRIOR TO CAPPING EXISTING 10" AND 8" FORCE MAINS AND REMOVING OF PIPELINES AND UTILITIES, CONTRACTOR SHALL DEWATER AND FLUSH WITH CLEAN WATER THE UTILITY AND FILL UTILITIES WITH 12" MIN. CONCRETE BULK HEAD. CONTRACTOR SHALL DISPOSE OF DEWATERED SEWER FLOWS AND FLUSHED WATER AT A TREATMENT PLANT APPROVED TO ACCEPT AND TREAT THIS WATER. THE CONTRACTOR SHALL BE FULLY RESPONSIBLE FOR THE TRANSPORT, TREATMENT AND DISPOSAL OF THESE WATERS PER STATE AND LOCAL CODES. AS AN OPTION, CONTRACTOR MAY DISPOSE OF DEWATERED SEWER FLOWS INTO THE DISTRICT'S SEWER SYSTEM. IF CONTRACTOR CHOOSES THIS OPTION, CONTRACTOR SHALL REMOVE ALL SOLIDS PRIOR TO DISPOSAL INTO THE DISTRICT'S SEWER SYSTEM. CONTRACTOR SHALL PROPERLY DISPOSE OF ALL SOLIDS REMOVED AT A LANDFILL APPROVED TO ACCEPT THIS WASTE. THE CONTRACTOR SHALL BE FULLY RESPONSIBLE FOR THE TRANSPORT AND DISPOSAL OF THIS WASTE PER STATE AND LOCAL CODES.
- CONTRACTOR SHALL PROVIDE FOR ROUGH GRADING AND COMPACTION FOR AREAS WHERE WET WELLS, VALVE VAULTS, FENCING AND ANY OTHER STRUCTURES AND PIPE REMOVAL WAS CONDUCTED TO PROVIDE FOR A SMOOTH AREA WITHIN THE DEMOLITION AND REMOVAL AREAS. DEMOLITION/REMOVAL AREAS WITHIN PAVED AREAS SHALL BE BACKFILLED AND PROPERLY COMPACTED AND PAVED PER PLANS AND SPECIFICATIONS.
- PRIOR TO CUTTING AND CAPPING OR REMOVING OF UTILITIES TO BE ABANDONED OR REMOVED, THE CONTRACTOR SHALL VERIFY WITH SAID UTILITY AGENCY/COMPANY THE LOCATIONS OF SAID UTILITIES.
- FOR AREAS NOT IN PAVED OR UNPAVED ROADS, CONTRACTOR SHALL PROVIDE AND MAINTAIN A MINIMUM OF 6' TALL TEMPORARY FENCING AROUND THE DEMOLITION SITE TO PROVIDE FOR SITE SECURITY DURING DEMOLITION. IF ADDITIONAL SECURITY IS REQUIRED, CONTRACTOR SHALL PROVIDE AT NO ADDITIONAL COST TO THE CONTRACT.
- SEE SPECIFICATION SECTION SPECIAL REQUIREMENTS SECTION 20 FOR ADDITIONAL REQUIREMENTS AND DETAILS. SEE APPENDIX FOR RECORD DRAWINGS OF EXISTING FACILITIES.

TABLE FOR LIMITS OF AC OVERLAY

STREET SECTION	STATION RANGE OF SECTION	LIMITS OF AC OVERLAY
WINEVILLE AVENUE	STA. 10+00 TO STA. 12+30 STA. 12+30 TO STA. 21+18 STA. 21+18 TO STA. 26+60 STA. 26+60 TO STA. 35+50	NONE LANE LINE TO LANE LINE 2 LANES LANE LINE TO LANE LINE LANE LINE TO LANE LINE
SHAFT LOCATIONS	VARIES	10' ON ALL SIDES
64TH STREET	STA. 10+00 TO STA. 23+50	S. EOP TO N. EOP
SMITH AVENUE	STA. 19+24 TO STA. 28+20	E. EOP TO W. EOP
LIMONITE AVENUE	STA. 10+10 TO STA. 10+70	10' W. OF TRENCH - 10' E. OF TRENCH
LUCRETIA AVENUE	STA. 10+55 TO STA. 13+00	E. EOP TO W. EOP
SKY COUNTRY DRIVE	STA. 10+00 TO STA. 24+30	S. EOP TO N. EOP

LEGEND:

- PROPOSED SEWER MAIN
- PROPOSED SEWER MANHOLE
- 8"FM— EXISTING SEWER FORCE MAIN (SIZE PER PLAN)
- 8"SS— EXISTING SEWER LINE (SIZE PER PLAN)
- E— EXISTING UNDERGROUND ELECTRIC LINES
- 12KV— EXISTING 12 KV ELECTRIC LINES
- 36"SD— EXISTING STORM DRAIN (SIZE PER PLAN)
- 2"G— EXISTING GAS LINE (SIZE PER PLAN)
- 30"HPG— EXISTING 30" HIGH PRESSURE GAS LINE
- 36"HPG— EXISTING 36" HIGH PRESSURE GAS LINE
- 8"W— EXISTING 8" WATERLINE
- W12"ACP— EXISTING 12" ACP WATERLINE
- 24"W— EXISTING 24" WATERLINE
- EXISTING EDGE OF PAVEMENT
- EXISTING RIGHT-OF-WAY
- EXISTING FENCE
- EXISTING WALL
- STREET CENTERLINE
- FUTURE CURB AND GUTTER
- EXISTING SEWER EASEMENT
- PROPOSED SEWER EASEMENT
- 15" S— EXISTING SEWER MAIN (SIZE NOTED)
- (MH)— EXISTING SEWER MANHOLE
- (SD)— EXISTING STORM DRAIN MANHOLE
- EXISTING POWER POLE
- EXIST. TRAFFIC SIGN, SIGNAL PULL BOX, SIGNAL CONTROL BOX, ETC.
- EXISTING ELECTRIC MANHOLE
- EXISTING UNDERGROUND TELEPHONE LINES
- PROPOSED ASPHALT OVER AB CLASS II
- PROPOSED WALL
- BLOCK WALL TO BE REMOVED
- SURVEY MONUMENT

ABBREVIATIONS:

- AB AGGREGATE BASE
- AC ASPHALT CEMENT
- ACP ASBESTOS-CEMENT PIPE
- AVE AVENUE
- B.O. BLOW OFF
- C&G CURB AND GUTTER
- CB CATCH BASIN
- CF CURB FACE
- CP CATHODIC PROTECTION
- CL CENTERLINE
- DIA DIAMETER
- DR DRIVE
- DWG DRAWING
- E OR E. EAST
- EG EXIST. GRADE
- ELEC. ELECTRICAL
- ESMT EASEMENT
- EP EDGE OF PAVEMENT
- EX EXISTING
- FL FIRE HYDRANT
- FL FLOW LINE
- FS FINISH SURFACE
- G GAS
- INV INVERT ELEVATION
- J.C.S.D. JURUPA COMMUNITY SERVICES DISTRICT
- MAX. MAXIMUM
- MH MANHOLE
- MIN. MINIMUM
- N OR N. NORTH
- SD STORM DRAIN
- PVC POLYVINYL CHLORIDE PIPE
- PROP. PROPOSED
- R/W RIGHT OF WAY
- S OR S. SOUTH
- STA STATION
- STD. STANDARD
- ST STREET
- T TELEPHONE
- TC TOP OF CURB
- W OR W. WEST



DATE	BY	MARK	REVISIONS	APPR. DATE

DESIGNED BY: CAB DRAWN BY: CY CHECKED BY: WTM

RECOMMENDED FOR APPROVAL	
CHECKED:	
DATE:	



PREPARED UNDER THE SUPERVISION OF:
Albert A. Webb
R.C.E. NO. C81075

ALBERT A. WEBB ASSOCIATES
ENGINEERING CONSULTANTS
3788 MCCRAY STREET
RIVERSIDE CA. 92506
PH. (951) 686-1070
FAX (951) 788-1256

SCALE: N.T.S. BENCHMARK: SEE SHEET 1

JURUPA COMMUNITY SERVICES DISTRICT
RIVERSIDE COUNTY, CALIFORNIA
SKY COUNTRY TRUNK SEWER
INDEX MAP AND ABBREVIATIONS

FOR: J.C.S.D. PN C133526 W.O. 2011-0167

SHEET 2
OF 18 SHEETS
DWG. NO. 11-167

FILE:G:\2011\11-0167-C-SK-DWG & PROJ\B\C133526-0167-C-SK-DWG 11/18/2016 12:53:12 PM